

WS 50A 电缆剥皮器

Warning! This tool is not protected against electrical shock! This tool is not to be used for purposes other than intended. Read carefully and understand instructions before using this tool.

备注: 此工具特为切割10KV~35KV 电力电缆的主绝缘,工作范围从12.7毫米到57.15毫米

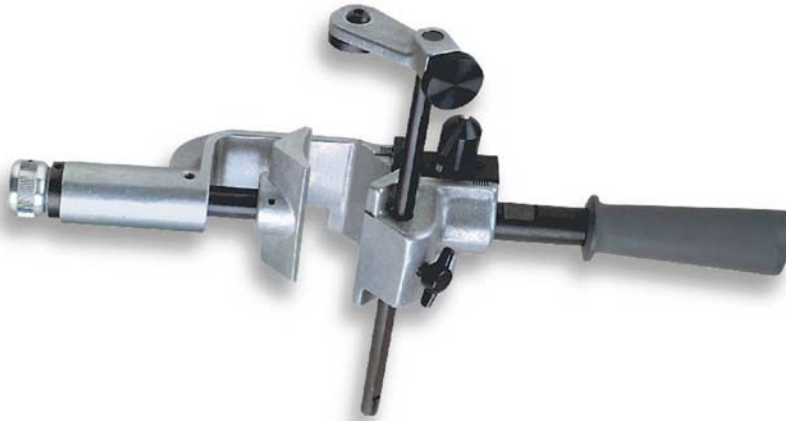

操作说明

- 1.将要剥皮的电缆卡入工具中,并用工具上部的旋转螺母缩紧。
- 2.这个时候工具刀片是在电缆的上方,现在松下刀片调节扳手,使刀片到达要剥离的电缆内半导体处。
- 3.注意刀片的距离需距离内半导体层0.8MM 处为最佳角度。
- 4.旋转工具, 直至需要的导体长度暴露。
- 5.定位棒用于定位, 上面的旋转面板用来顶住被暴露的导体断面, 这样刀具就自然停止了。

注: 两种刀片可以更换, CB 50 和CB50A。

WARRANTY: The Ripley Company warrants that our line of tools are free of defect and fully operable at the time of shipment. The warranty is limited to the repair or replacement of any product which proves to be defective in material or workmanship, under normal use and service.)



46 Nooks Hill Road
Cromwell, CT 06416
Phone: 800-528-8665
Int'l: (01) 860-635-2200
Fax: (01) 860-635-3631
e-mail: info@ripley-tools.com
Internet: www.ripley-tools.com



37661
8/4/03 SB rev 2